



KH/LH
February 2017

Dear Resident

RESIDENT CONSULTATION ON A NEW CAR PARK

The Town Council have received a public question asking if the Council would consider providing additional car parking facilities for Oxclose Primary School within the Dene Area of Spennymoor to ease the perceived parking problems at the school during childrens' drop off and collection times.

Following this request, the Council have developed three different options and costs for you to comment on. These options and costs are enclosed for your attention and consideration.

We would therefore like to consult with you on this matter, to identify your views on this proposal and would be grateful if you could complete the enclosed questionnaire and return it to the Town Hall by the 24th February 2017 to enable us to collate all responses.

We will of course publish the results of the consultation, and the Council's decision on the matter.

Can I thank you in advance for your support in this matter.

Yours sincerely

Katherine Hierons MBA LLB PG Dip
Town Clerk.
Enc.



**RESIDENT CONSULTATION ON ADDITIONAL CAR PARKING
AT THE DENE IN SPENNYMOOR**

Please provide your name and address, and complete and return the document to the Town Clerk at the Town Hall in Spennymoor.

Name

Address

Please underline your preferred answer.

1. As a local resident do you consider car parking to be a problem during drop off and collection times at Oxclose Primary School? **YES or NO**
2. Would you like the Town Council to provide additional car parking at the Dene area in Spennymoor? **YES or NO.**
3. If you have answered **YES** to question two, please tick your preference from these three options:
 - **Option 1; 12 Car Parking Spaces at a cost of £28,125**
 - **Option 2; 20 Car Parking Spaces at a cost of £39,836**
 - **Option 3; 29 Car Parking Spaces at a cost of £56,458**
4. If you have an alternative solution to the problem other than the one being proposed could you please describe here -

Can I thank you for taking the time and trouble to complete this form. Please return it to the Town Clerk at the Town Hall in Spennymoor by the 24th February 2017 to enable the Town Council to collate and publish the results.

Katherine Hierons MBA LLB PG Dip
Town Clerk

Appendix 2

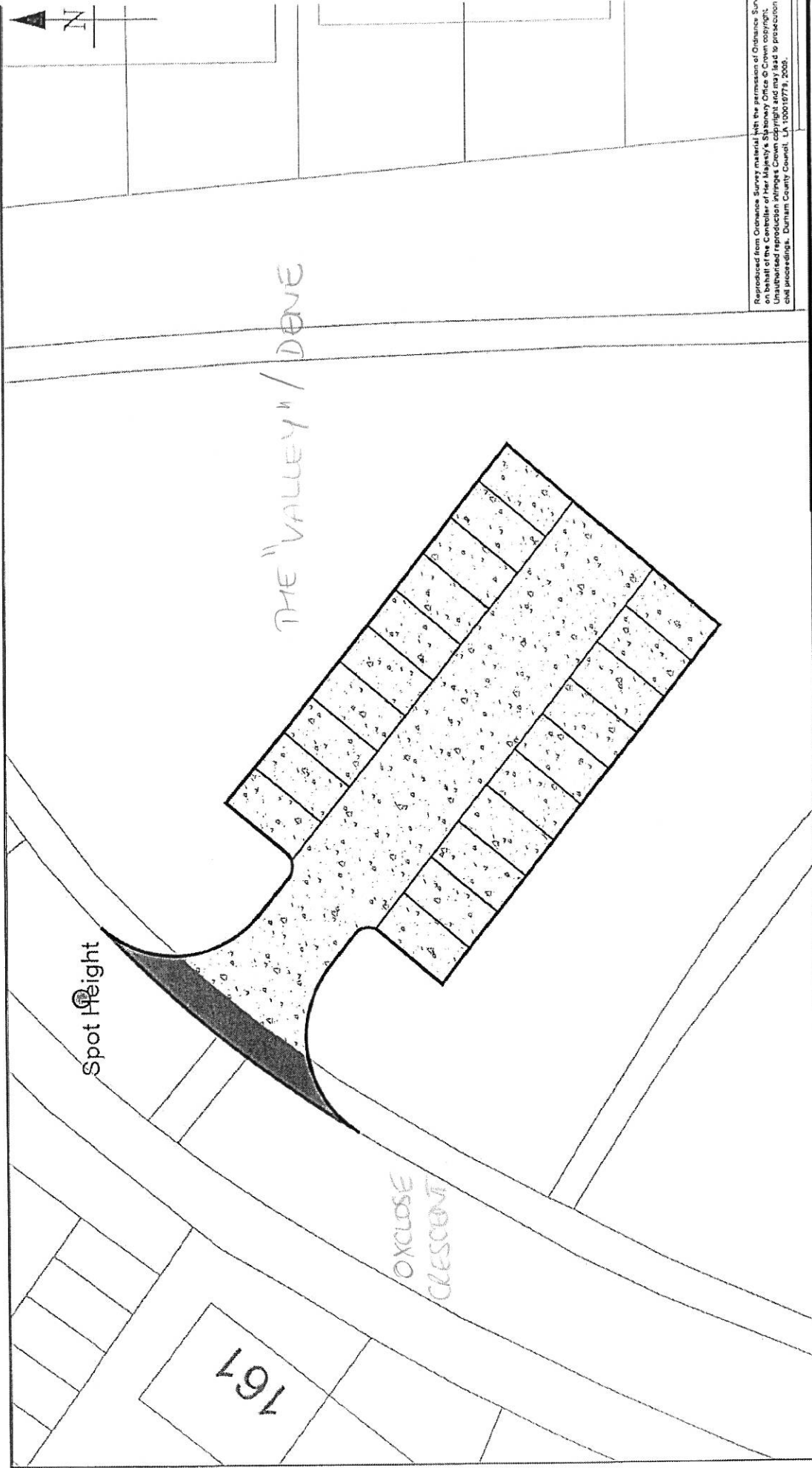

Reproduced from Ordnance Survey material with the permission of Ordnance Survey on behalf of the Controller of Her Majesty's Stationery Office © Crown copyright. Unauthorised reproduction infringes Crown copyright and may lead to prosecution, civil proceedings. Durham County Council. LA 100018779, 2008.



HIGHWAYS SERVICES GROUP
CORPORATE DIRECTOR OF HIGHWAYS SERVICES
COUNTY HALL, SPENNYMOOR, DH3 5UG

Project
Ox Close Crescent, Spenny Moor

Drawing
Parking Area Feasibility - Option 2

Scales
1/200 @ A3

Project/Drawing No.
OCC/DU/02

Rev. (

Ref/Amend	Drawn By	Name	Date	Approved By	Name	Date	Sign	Description Of Amendments
D/-	D. Lawlor	A. Ramsey	23/08/16	A. Ramsey	A. Ramsey	23/08/16	<i>(Signature)</i>	

Legend

- Existing topsoil to be excavated and disposed, lay flexible footway construction to a depth of 305mm as Highway Detail HUS/11/26.
- Existing footpath to be excavated and disposed, lay flexible footway construction to a depth of 305mm as Highway Detail HUS/11/26.
- Take up and dispose existing kerbing.
- Lay new kerbing consisting of two 6m radius, two 1m radius and 125mm x 255mm bullheaded straight to HUS/11/08

NOTES

- Lay white lining for 20 no parking bays.
- Adjust any existing covers, as agreed on site, to carriageway level.

PATH:



Legend

- Existing topsoil to be excavated and disposed, by feasible highway construction to a depth of 305mm as Highway Data HMS/1126.
- Existing footpath to be excavated and disposed, by feasible highway construction to a depth of 305mm as Highway Data HMS/1126.
- Take up and dispose existing kerbing.
- Lay new kerbing consisting of two 6m radius, two 1m radius and 125mm x 255mm bullheaded straight to HMS/1108

Notes

- Lay white lining for 20 no parking bays.
- Adjust any existing covers, as agreed on site, to carriageway level.

Rev

Rev	Amtd	Drawn By	Drawn By Name	Date	Approved By	Approved By Name	Date	Sign
01		D. Leeder		27/08/16	A. Ramsey		23/08/16	6/2/2000

Description of Attachments:

Project: Ox Close Crescent, Spennymoor

Drawing: Parking Area Feasibility - Option 3

Scale: 1/200 @ A3

Project/Drawing No.: OCC/DL/03

Rev: 01

Durham County Council
HIGHWAYS SERVICES GROUP
 CORPORATE DIRECTOR OF NEIGHBOURHOOD SERVICES
 COUNTY HALL, BYELAND, DH1 1TD

P.A.T.H.

